



# Progressing New Hospital Plans

making a

difference

together



## Introduction & Aims of the Event

Overview of where we are now

Opportunity to engage with current thinking

To inform the process for Business Case Development

Size/ Scale

Site Options

Developing Therapeutic environments

Next Steps



making a



difference



together



## How this session will work

- Presentation & Table Work
- Information collated
- Inform Business Case Development



making a



difference



together



# SESSION 1

making a

difference

together



## What size of Hospital do we need?

- Starting point
- Shift from beds to community investment
- Recovery approach
- Informed by:
  - Community Plans
  - National data/ benchmarks
  - Best practice including information from Royal College of Psychiatry
  - TEWV information
  - Value for money



making a



difference



together



## What size of Hospital do we need

- Design Vision
- Functional Relationships
- Schedule of Accommodation
- External Space

making adifferencetogether

# Bed Models

- 
- National models have informed our bed analysis
  - Population modelled using PRAMH (Person Based Resource Allocation for Mental Health).
  - 2 Stage model
    - Adults 18-64,
    - Older People 64+
  - Base population extracted from registered GP lists
  - We have used this data to look at the different variables/ assumptions to meet this bed modelling



making a



difference



together





## Beds

	Adult	MHSOP	Total
Maximum (PRAMHS)	45	32	77
Minimum (PRAMHS)	22	19	41
Median (National)	29	31	60
Minimum (National)	24	22	46
TEWV benchmarks	18	21	39



making a



difference



together





## Estate expectations

- 4 wards – 60 beds
  - Single sex (male/ female)
  - 2 wards adult beds
  - 2 wards MHSOP beds
  - No mix of functional/ organic (dementia)
- Related ward space
  - Including therapy, day rooms, outdoor space
- 136 Suite (place of safety)
- Crisis Team accommodation



making a



difference



together



## Estate expectations

- Community teams are located elsewhere (Community Hubs) – including outpatient space
- Management suite (including training space) located elsewhere
- Psychiatric Intensive Care Unit (PICU) – continue to access Middlesbrough and Darlington due to specialist nature of care
- Inpatient care around other specialist services including Mother and Baby unit / Specialist Affective services remain as per current pathways



making a



difference



together



# What size of Hospital do we need

## ● Design Vision

- Scope / Services – Patient Group, Numbers (Patients & Staff)
- Clinical Functions, Space requirements
- Purpose of building / General Requirements / Accessibility
- Priorities
- Constraints
- Flexibilities (Service & Design)
- Futureproofing



making a



difference



together



## Schedule of Accommodation (SoA m2)

- Subject to Design Workshops
- Clinical Reviews
- User & Carer Reviews
  - Clinical Requirements
  - User Requirements & Expectations
  - Furniture & Equipment
  - Fixtures & Finishes – Decoration – Colour schemes
  - Artwork



making a



difference



together



## Schedule of Accommodation (SoA m2)

- Subject to reviews (e.g.) m2 requirements

● AMH (male)	700
● AMH(female)	700
● MHSOP (Organic)	700
● MHSOP (Functional)	700
● Shared (inc 136, crisis...)	1400
● (Circulation/Plant etc...)	1400
● <b>TOTAL</b>	<b>5600m2 (c. 5 acres)</b>

making adifferencetogether



# GROUP WORK

making a difference together



- Do you understand our rationale/ approach for the scope for the new hospital?
- What do you like?
- What issues concern you?
  
- Your facilitator will collate your feedback
- We will keep you to time (20 mins)



making a



difference



together



# SESSION 2

making a

difference

together





## What sites are available?

- Based on the broad number of beds/ space required
- Long list of sites
- Some sites subject to planning/ agreements with landlords/ land sales/ restrictions
- We have “mocked up” a proposed site solution but this will not be the final design
- We want your feedback on the advantages and disadvantages of these site options



making a



difference



together



## What sites are available

- Clinical Option Appraisals (including location / accessibility)
- Engagement feedback
- Achievability (Size, Time, Planning, Design & Ground conditions)
- Affordability (including Procurement – Land & Capital costs £)

making adifferencetogether



# Option 1 – Bootham Park Hospital

making a

difference

together



# Bootham Park Hospital



making a

difference

together



# BPH - Site



making a

difference

together



# BPH - Site

Part One: Understanding the City > Character Areas > One: Bootham Park

- Grade I Listed Building
- Grade II\* Listed Building
- Grade II Listed Building
- Building of merit
- Detractor
- Conservation Area boundary
- Character area boundary

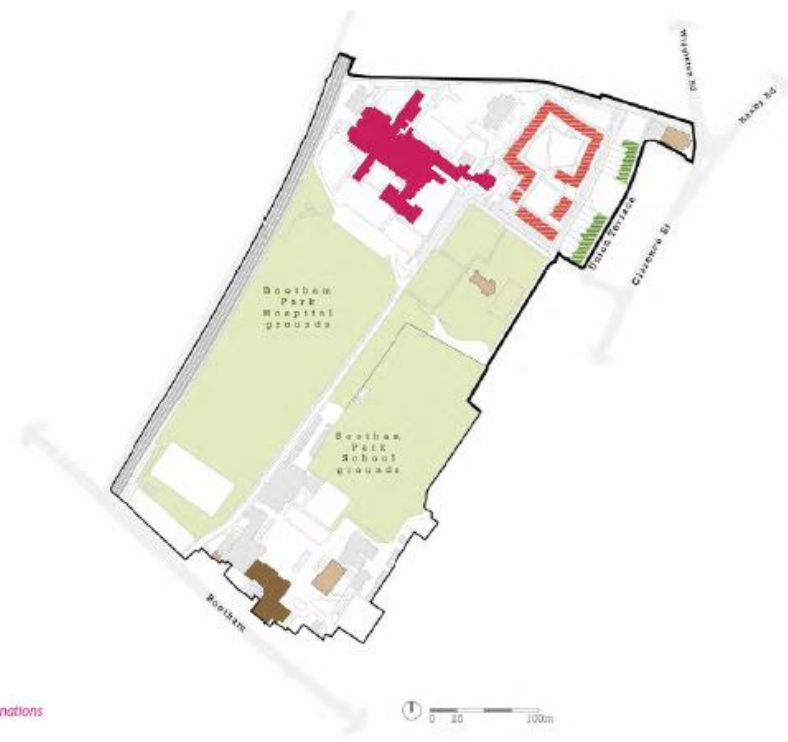

Designations

making a

difference

together

# English Heritage – Grade I Listing

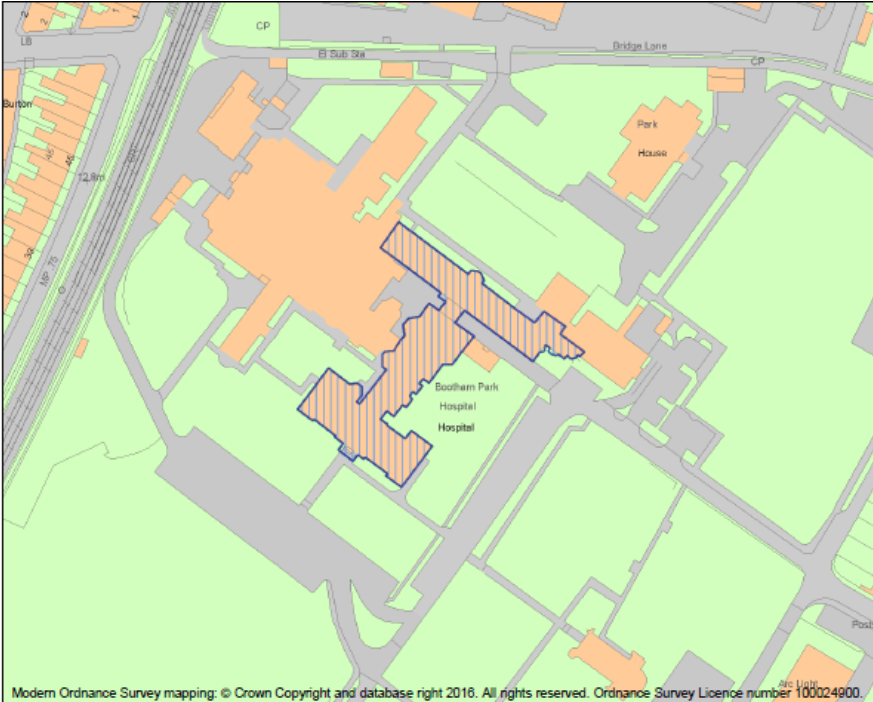

Modern Ordnance Survey mapping: © Crown Copyright and database right 2016. All rights reserved. Ordnance Survey Licence number 100024900.

This is an A4 sized map and should be printed full size at A4 with no page scaling set.

<b>Heritage Category:</b>	
Listing	
County:	
District: York	
Parish: Non Civil Parish	
<p>For all entries pre-dating 4 April 2011 maps and national grid references do not form part of the official record of a listed building. In such cases the map here and the national grid reference are generated from the list entry in the official record and added later to aid identification of the principal listed building or buildings.</p> <p>For all list entries made on or after 4 April 2011 the map here and the national grid reference do form part of the official record. In such cases the map and the national grid reference are to aid identification of the principal listed building or buildings only and must be read in conjunction with other information in the record.</p> <p>Any object or structure fixed to the principal building or buildings and any object or structure within the curtilage of the building, which, although not fixed to the building, forms part of the land and has done so since before 1st July, 1948 is by law to be treated as part of the listed building.</p> <p>This map was delivered electronically and when printed may not be to scale and may be subject to distortions.</p>	
Grid Reference:	SE6011152806
Map Scale:	1:1250
Print Date:	23 March 2016

Number: 1259396\_2

Name: Bootham Park Hospital: front range, 1886 link block, late-C18 building, 1817 range and 1908 extension.



HistoricEngland.org.uk

making a

difference

together

# English Heritage – Grade I Listing – Updated May 2016

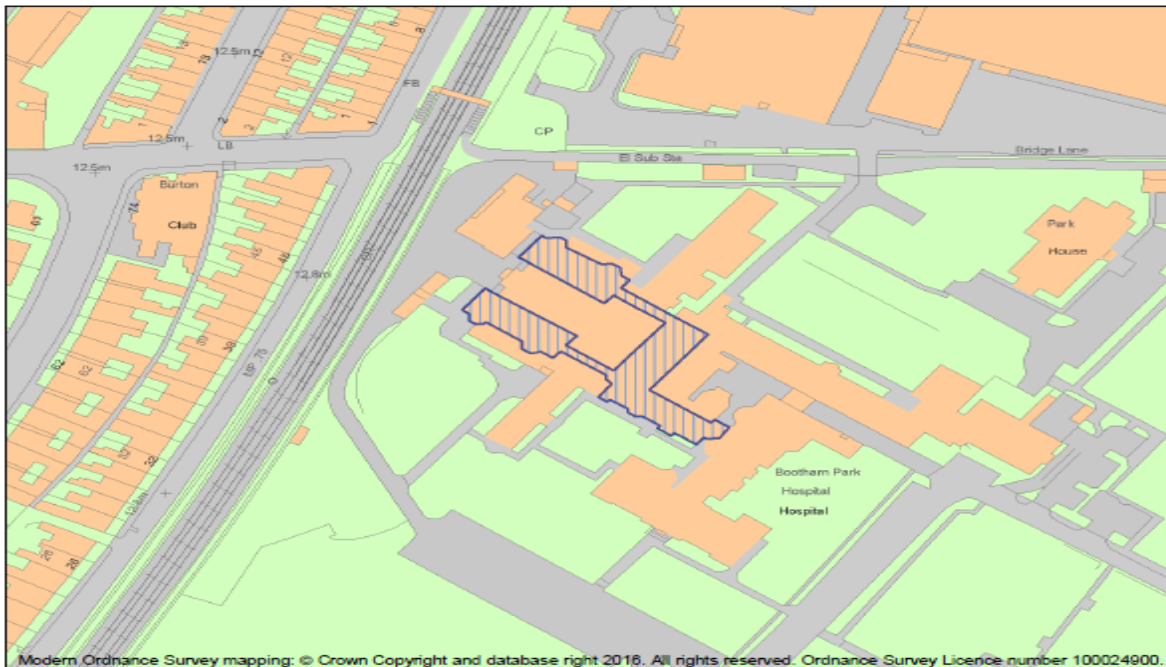

This is an A4 sized map and should be printed full size at A4 with no page scaling set.

**Number:** 1434284 \_1

**Name:** Bootham Park Hospital: Two long corridors, recreation hall, former American bowling alley, and two former Pauper Wards

**Heritage Category:**  
Listing

**County:**

**District:** York

**Parish:** Non Civil Parish

For all entries pre-dating 4 April 2011 maps and national grid references do not form part of the official record of a listed building. In such cases the map here and the national grid reference are generated from the list entry in the official record and added later to aid identification of the principal listed building or buildings.

For all list entries made on or after 4 April 2011 the map here and the national grid reference do form part of the official record. In such cases the map and the national grid reference are to aid identification of the principal listed building or buildings only and must be read in conjunction with other information in the record.

Any object or structure fixed to the principal building or buildings and any object or structure within the curtilage of the building, which, although not fixed to the building, forms part of the land and has done so since before 1st July, 1948 is by law to be treated as part of the listed building.

This map was delivered electronically and when printed may not be to scale and may be subject to distortions.

**Grid Reference:** SE6006852834

**Map Scale:** 1:1250

**Print Date:** 23 March 2016

 Historic England  
HistoricEngland.org.uk

making a

difference

together



# English Heritage – Grade I Listing – Updated May 2016

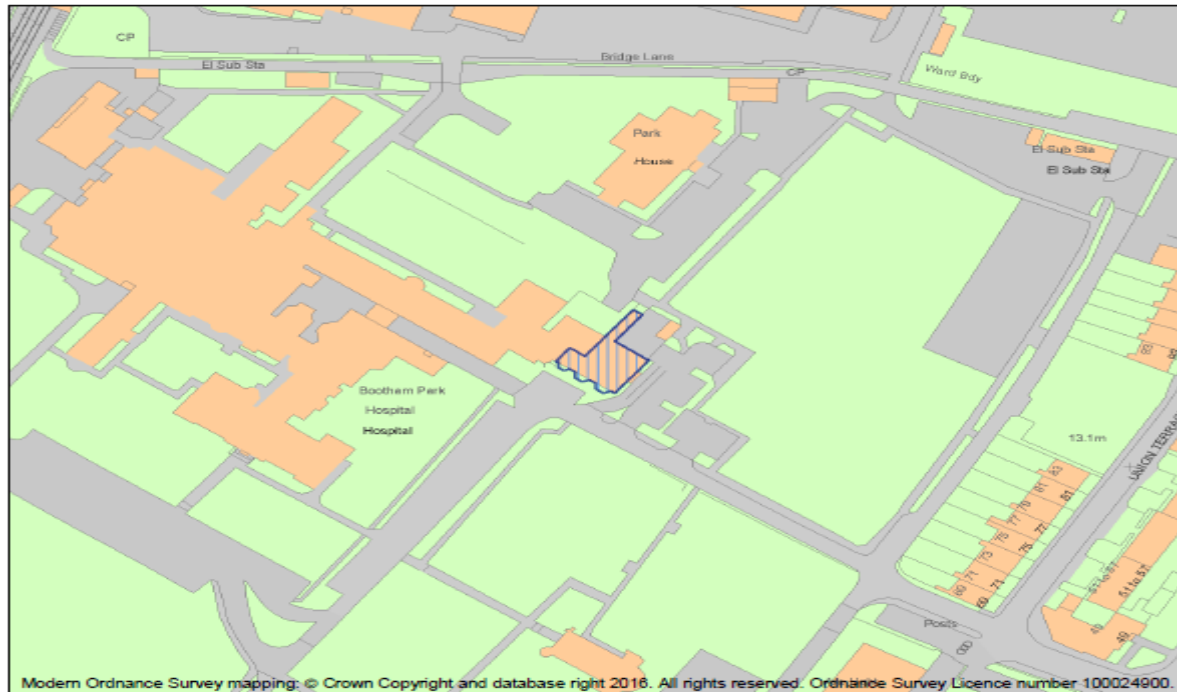

**Heritage Category:**  
Listing

**County:**

**District:** York

**Parish:** Non Civil Parish

For all entries pre-dating 4 April 2011 maps and national grid references do not form part of the official record of a listed building. In such cases the map here and the national grid reference are generated from the list entry in the official record and added later to aid identification of the principal listed building or buildings.

For all list entries made on or after 4 April 2011 the map here and the national grid reference do form part of the official record. In such cases the map and the national grid reference are to aid identification of the principal listed building or buildings only and must be read in conjunction with other information in the record.

Any object or structure fixed to the principal building or buildings and any object or structure within the curtilage of the building, which, although not fixed to the building, forms part of the land and has done so since before 1st July, 1948 is by law to be treated as part of the listed building.

This map was delivered electronically and when printed may not be to scale and may be subject to distortions.

**Grid Reference:** SE6016452803  
**Map Scale:** 1:1250  
**Print Date:** 23 March 2016

 Historic England  
HistoricEngland.org.uk

**Number:** 1434279\_1

**Name:** Bootham Park Hospital: Medical Superintendent's House

This is an A4 sized map and should be printed full size at A4 with no page scaling set.

making a

difference

together

# Bootham Park Hospital(BPH) – Current Site

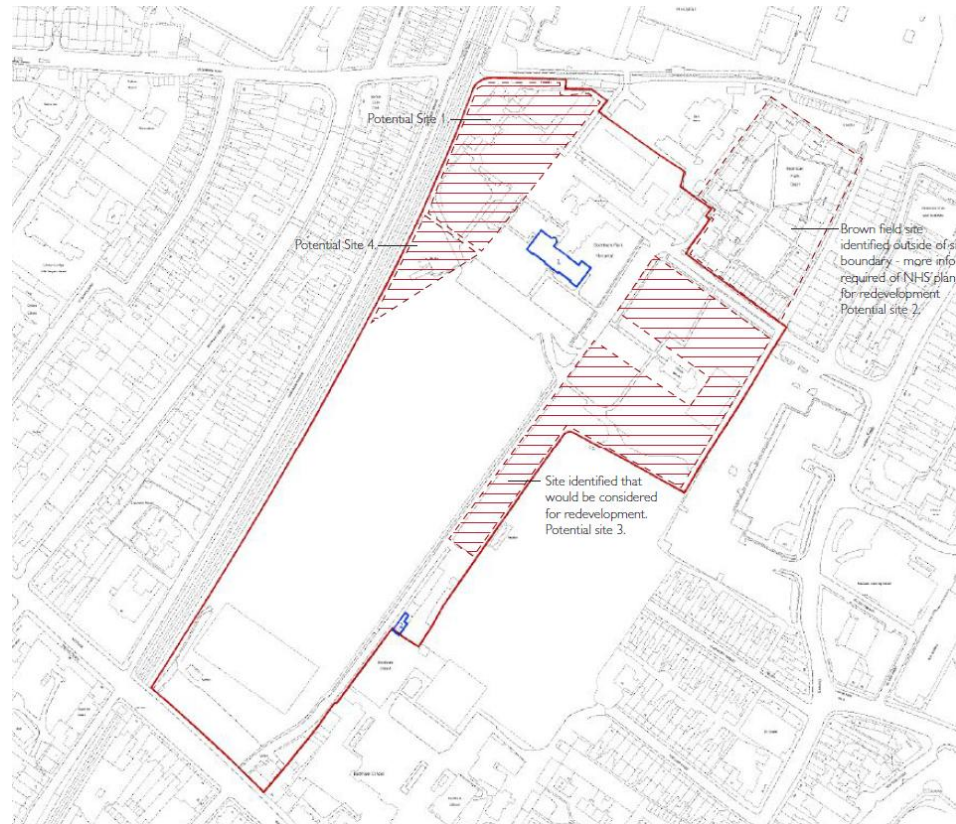

making a

difference

together

# BPH – Potential Development (& car park)

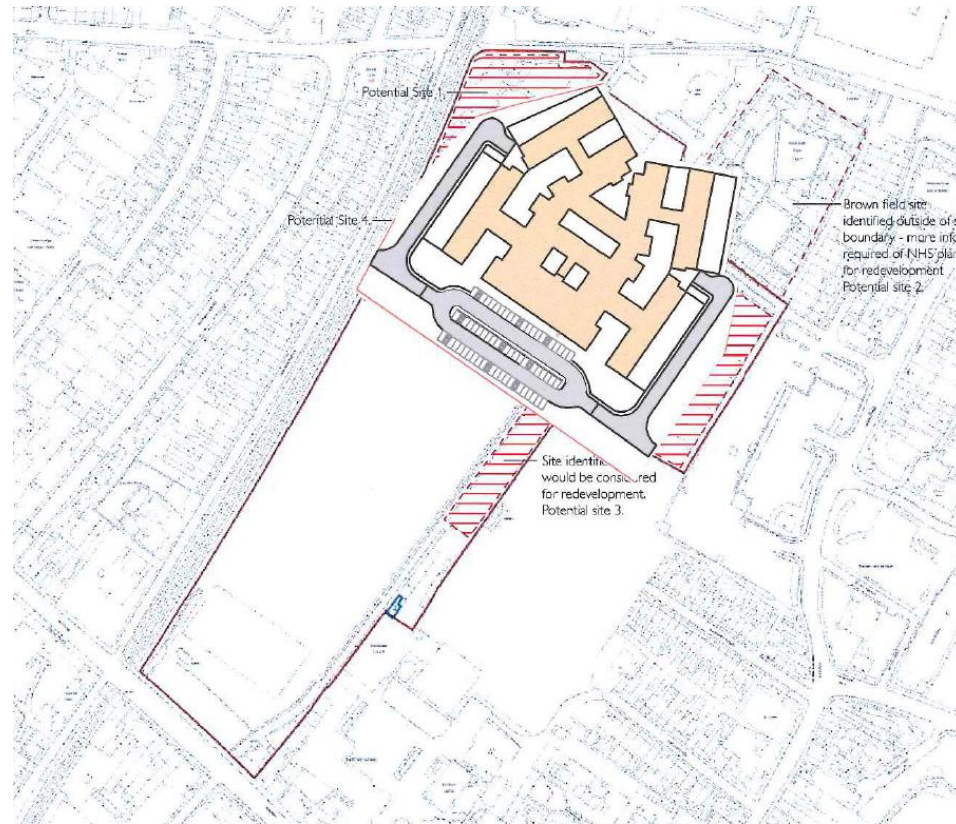

making a

difference

together



# Option 2 - Limetrees

Site size = 522m



making a

difference

together



# Option 3 -The Retreat site

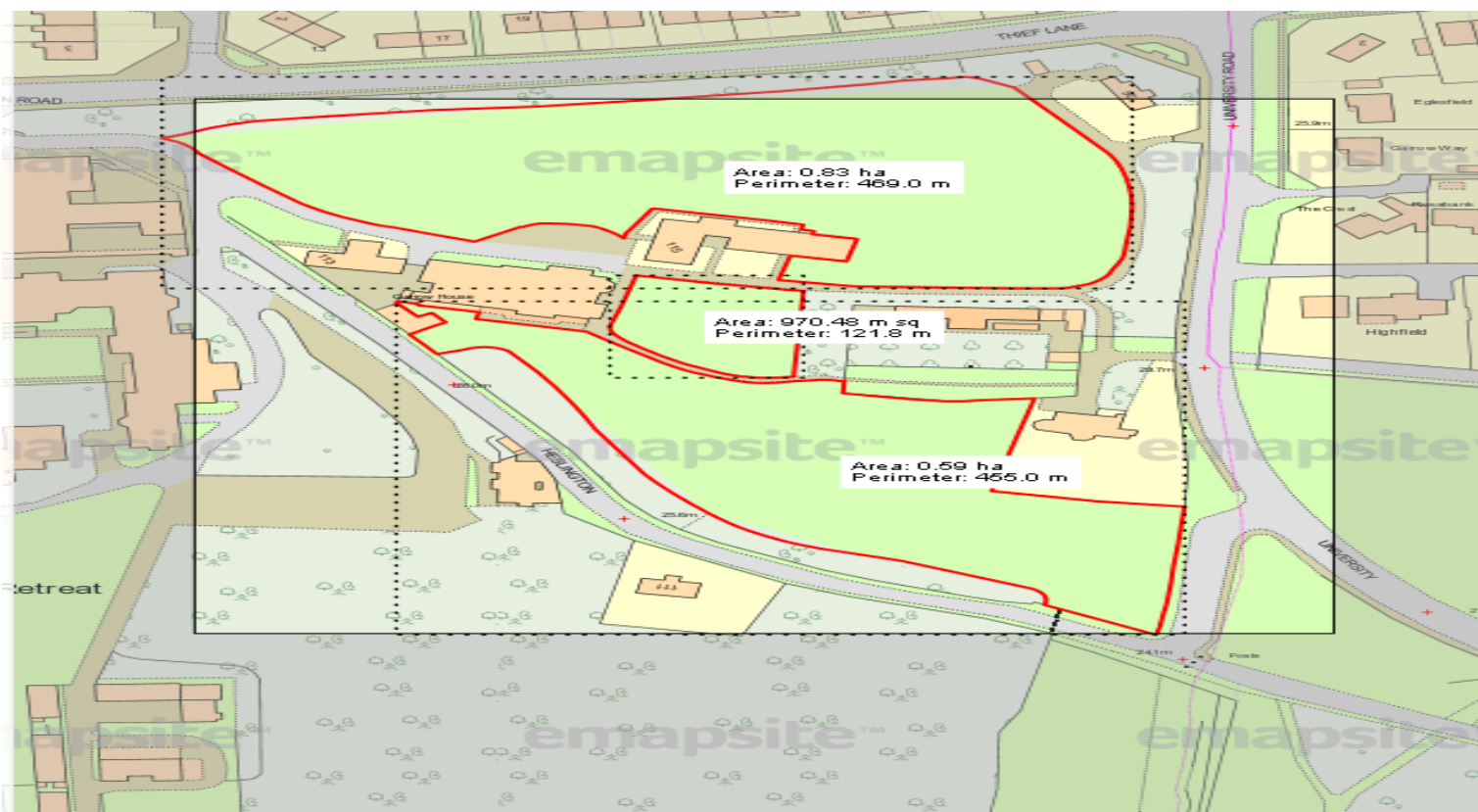

making a

difference

together

# Option 3 The Retreat site



making a

difference

together



# Option 4 – Clifton Site

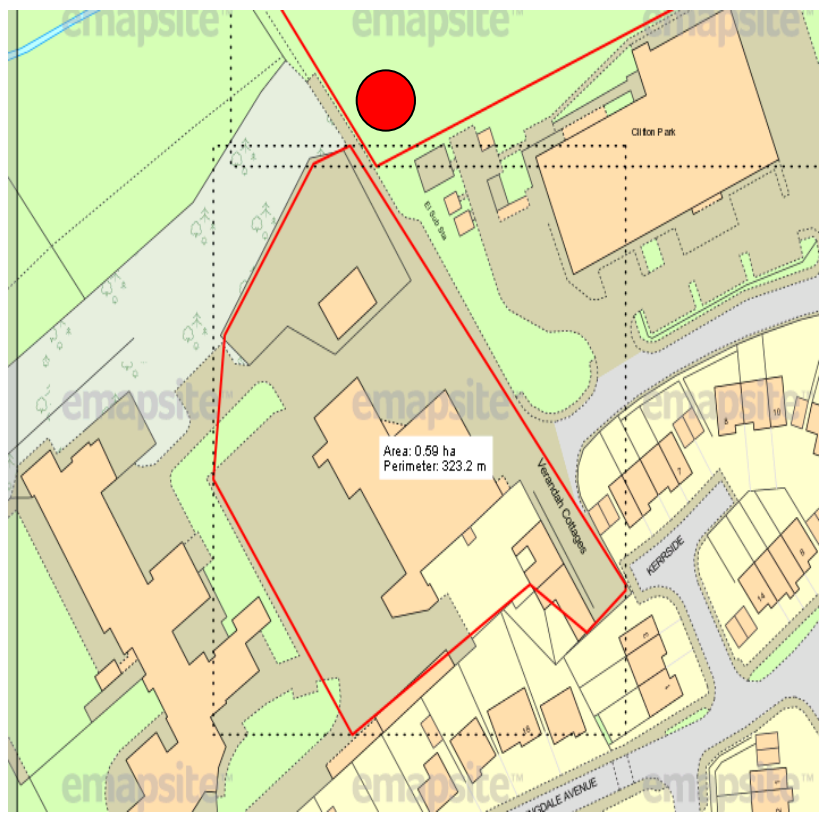
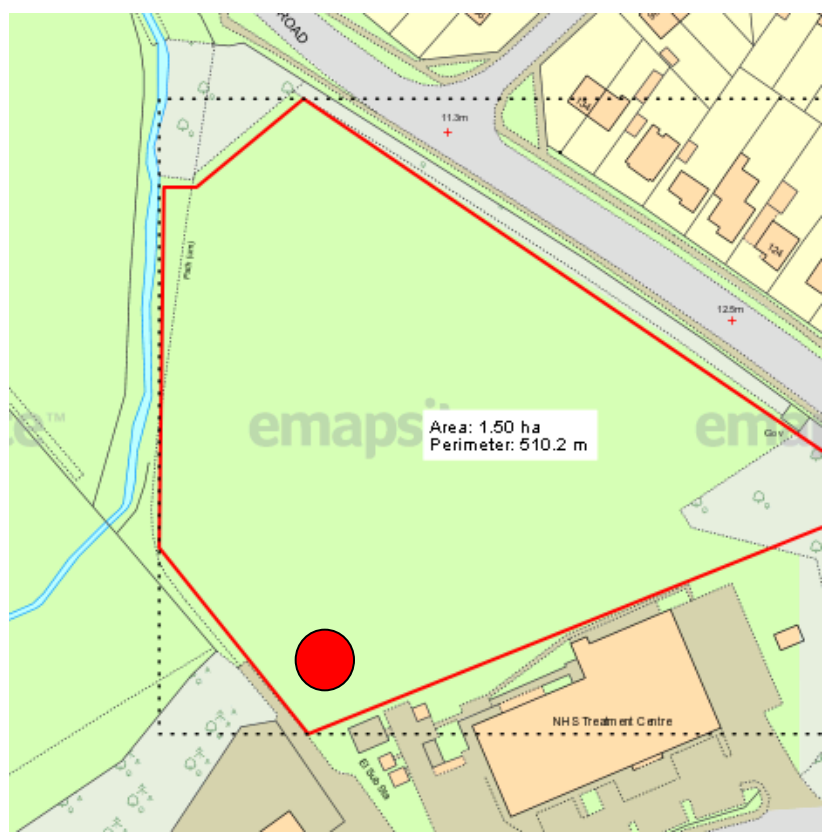

making a

difference

together



# Option 4 – Clifton Site



making a

difference

together





## Option 5 Reuse existing estate

- Current Inpatient Use
  - Peppermill,
  - Meadowfields,
  - Cherrytree,
  - Acomb,
  - Worsley
- Pending review re : future use

making adifferencetogether



## Other Long List Options (pending Reviews)

- Brook Nook, Osbaldwick
- Millfield Lane, Poppleton
- Moorside, Monks Cross
- Haxby Road
- Fulford & Naburn
- Lowfield (Acomb)
- Earswick
- Borobridge Road



making a



difference



together



# Site Options (map)

- ★ Brook Nook
- ★ Millfield Lane
- ★ Moorside Monks Cross
- ★ Fulford YO19 4TA
- ★ York High School
- ★ Earswick Huntingdon YO32 9...
- ★ Boroughbridge Road
- ★ Haxby Road York YO31 8SD
- ★ Clifton Park YO30 5RA

- Peppermill
- Meadowfields
- Cherrytree House
- Acomb Garth
- Worsley Court
- Bootham Park Hospital
- The Retreat
- Clifton

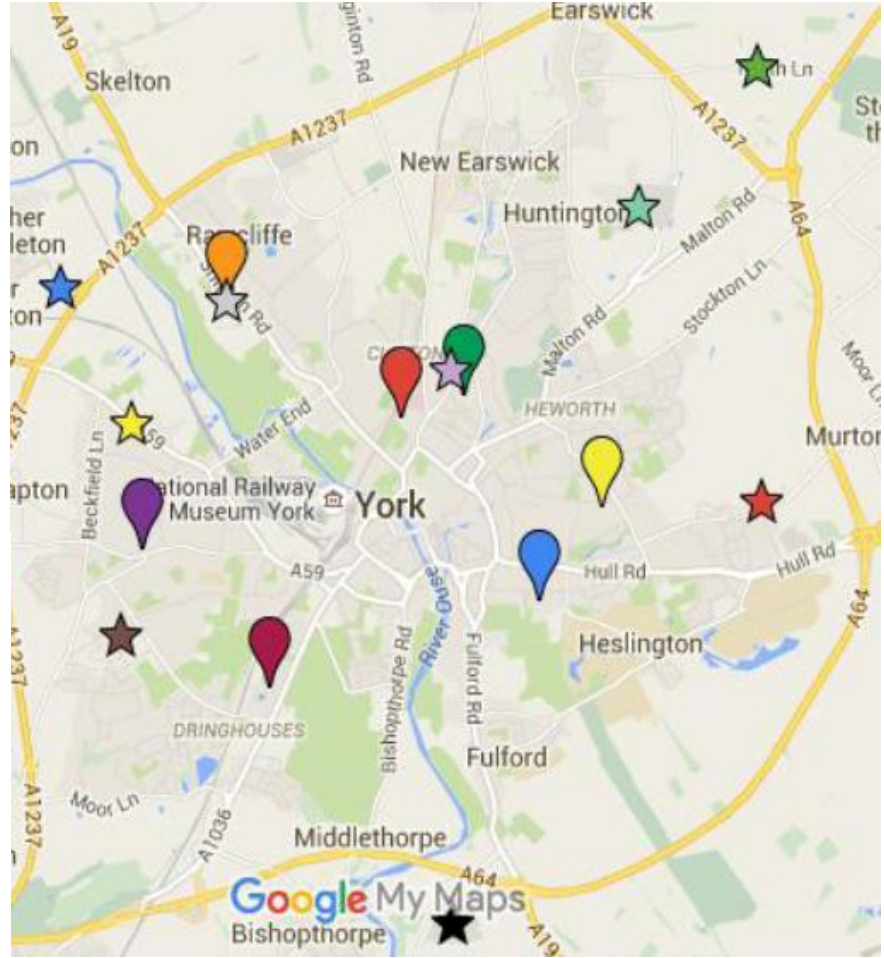

making a

difference

together



- What are the pros and cons of each site?
- Your facilitator will collate your feedback
- We will keep you to time (20 mins)

making a

difference

together



# SESSION 3

making a

difference

together



## Design Factors – how do create the most therapeutic space?

- As part of our design brief we need to create a safe, therapeutic environment for patients
- There are a number of estate guides that we need to follow
- Patient and Carer feedback/ involvement in design
- Our own estates expertise and knowledge



making a



difference



together



# TEWV – Capital Experience

## ● Design & Building Standards

- Health building notes (HBNs) – DoH dementia friendly
- Heath Technical Memorandums (HTMs)
- Care Quality Commission (CQC)
- Kings Fund (Enhancing the healing environment – assessment tool)
- Dementia Services Development Centre (DSDC) – Stirling University
- Royal College of Psychiatrists – MH accreditation
- Statutory – Planning Approvals, Building regulations, DDA, Fire,
- Building Research Establishment Environmental Assessment Methodology
  - (BREAM) Energy & Sustainability standards



making a



difference



together



# Service Users – feedback

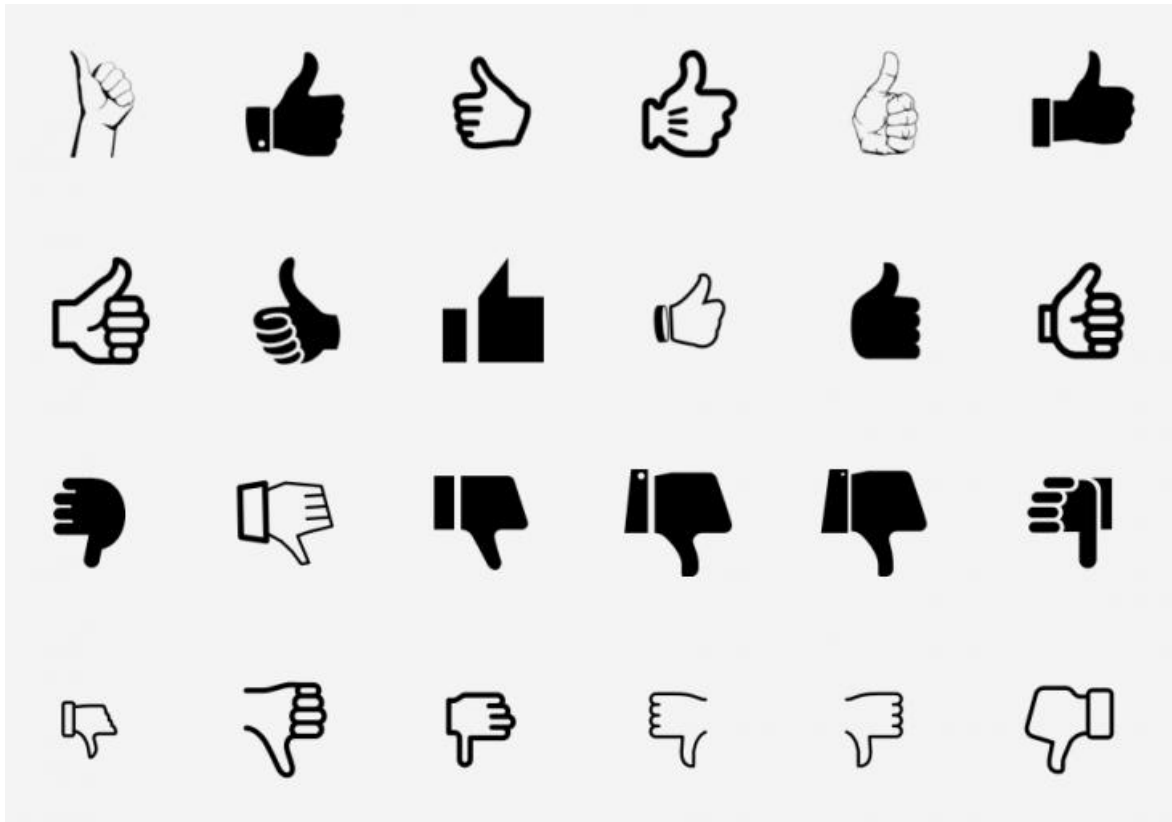

making a

difference

together





# Capital Scheme – e.g. Middlesbrough



making a

difference

together



# Capital Scheme – e.g. North Yorkshire



making a

difference

together



## e.g. Bedrooms



making a

difference

together



# e.g. Bedrooms



making a

difference

together



# e.g. Day Space - Lounge



making a

difference

together



# e.g. Day Space - Lounge



making a

difference

together

# e.g. Day Space – Lounge / Dining (CAMHS)



making a

difference

together



# e.g. Corridors



making a

difference

together



e.g. Entrance, reception, waiting...



making a

difference

together



# Plans – architects design to reality



making a

difference

together



# GROUP WORK

making a difference together

- 
- What is important in any new hospital and its design solution?
  - Is there anything which you feel that has not been covered and you want more information on?
  - Your facilitator will collate your feedback
  - We will keep you to time (20 mins)

making adifferencetogether



## Next Steps

- How we will use this information to inform our plans.
- Timetable for formal consultation
- Ongoing engagement with new hospital plans
- Ongoing engagement with other plans eg Community Hubs/ other developments

making adifferencetogether